

TABLE 1: VERTICAL REINFORCEMENT - BAR SIZES

PIER REINFORCEMENT TYPE	BAR MARK P1a & P2a BAR (1) TO (72) (BAR SIZE A)	BAR MARK P1b & P2b BAR (73) TO (106) (BAR SIZE B)	BAR MARK P1c & P2c BAR (107) TO (132) (BAR SIZE B)
11	40φ	40φ	40φ

SECTION 5
SCALE 1:10

Reviewed by NSTren
Jorge Müller
Jorge Müller
Project Director

This Drawing was originally prepared by JICA design team and reviewed/adjusted by NSTren Consortium

- NOTES:**
1. DIMENSION ARE IN MILLIMETERS.
 2. FOR OTHER NOTES RELATING TO THIS DRAWING REFER TO VIA00-ST-0602.

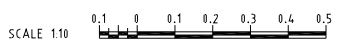

Last Modified by POLICARPIO-C7 / 12 Jul 2018
Filename: X:\Users\ACAD Shared\20180427_on Going To Submit\01_CP01 DRAWINGS\20180524_VIA00_VIA04_BR16_Changes Near Manilao\New Drawings From SMEC\NSCR-DWG-VIA00-ST-0615_A

VER	DATE	DESCRIPTION
01	04 JUL 2018	FIRST ISSUE DETAILED DESIGN

DEPARTMENT OF TRANSPORTATION
REPUBLIC OF THE PHILIPPINES

PHILIPPINE NATIONAL RAILWAYS

JICA JAPAN INTERNATIONAL COOPERATION AGENCY (JICA)

DESIGN CONSULTANT

JICA DETAILED DESIGN STUDY TEAM

ORIENTAL CONSULTANTS GLOBAL CO., LTD.

KATAHIRA & ENGINEERS INTERNATIONAL

PACIFIC CONSULTANTS CO., LTD.

JAPAN INTERNATIONAL CONSULTANTS FOR TRANSPORTATION CO., LTD.

TONICHI ENGINEERING CONSULTANTS INC.

TITLE	JDT	SMEC
DESIGNER	K. MIZUNO	R. ACOSTA, JR.
CHECK	I. HAYASHI	V. BALAKRISHNAN
TEAM LEADER	N. MATSUMOTO	J. BARNES
PROJ. MANAGER	M. MIYATA	R. YUZON, JR.

THE DETAILED DESIGN STUDY OF THE NORTH-SOUTH COMMUTER RAILWAY PROJECT (MALOLOS-TUTUBAN)

DETAILED DESIGN

PIER TYPE P2 - REINFORCEMENT DETAILS
SHEET 5

DATE	SCALE	SHEET No.	DRG No.	DRG S.	REV
JULY 2018	AS SHOWN		NSCR-DWG-VIA00-ST-0615		01

WPK-337

Last modified by MARINDO-C8 / 16 Jul 2018
Filename: X:\Users\ACAD Shared\20180427_on Going To Submit\01_CP01 DRAWINGS\20180524_VIA00_VIA04_BR16_Changes Near Marilao\New Drawings From SMEC\NSCR-DWG-VIA00-ST-0616_A

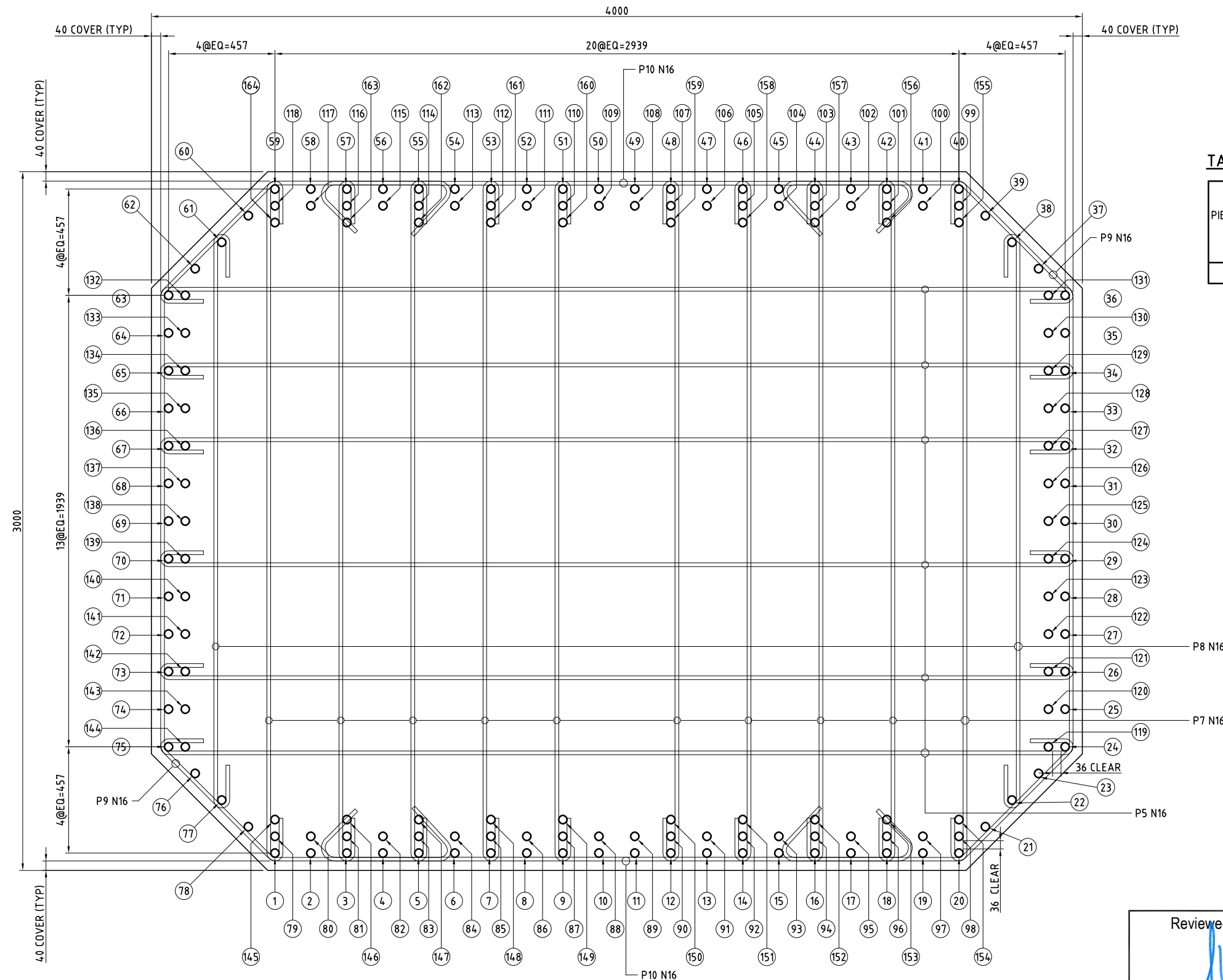

SECTION 6
SCALE 1:10

TABLE 1: VERTICAL REINFORCEMENT - BAR SIZES

PIER REINFORCEMENT TYPE	BAR MARK P1a & P2a BAR (1) TO (78) (BAR SIZE A)	BAR MARK P1b & P2b BAR (79) TO (118) (BAR SIZE B)	BAR MARK P1c & P2c BAR (119) TO (144) (BAR SIZE C)	BAR MARK P1d & P2d BAR (145) TO (164) (BAR SIZE D)
12	40φ	40φ	40φ	40φ

Reviewed by NSTren
Jorge Müller
Jorge Müller
Project Director

This Drawing was originally prepared by JICA design team and reviewed/adjusted by NSTren Consortium

- NOTES:**
1. DIMENSION ARE IN MILLIMETERS.
 2. FOR OTHER NOTES RELATING TO THIS DRAWING REFER TO VIA00-ST-0602.

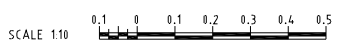





VER	DATE	DESCRIPTION
01	25 OCT 2017	REVISION CLOUDS REMOVED

 DEPARTMENT OF TRANSPORTATION
 REPUBLIC OF THE PHILIPPINES

 PHILIPPINE NATIONAL RAILWAYS

 JAPAN INTERNATIONAL COOPERATION AGENCY (JICA)

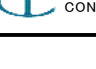
DESIGN CONSULTANT
 JICA DETAILED DESIGN STUDY TEAM
 ORIENTAL CONSULTANTS
 GLOBAL CO., LTD.
 KATAHIRA & ENGINEERS
 INTERNATIONAL
 PACIFIC CONSULTANTS
 CO., LTD.
 JAPAN INTERNATIONAL
 CONSULTANTS FOR
 TRANSPORTATION CO., LTD.
 TONICHI ENGINEERING
 CONSULTANTS INC.

TITLE	JDT	SMEC
DESIGNER	K. MIZUNO	R. ACOSTA, JR.
CHECK	I. HAYASHI	V. BALAKRISHNAN
TEAM LEADER	N. MATSUMOTO	J. BARNES
PROJ. MANAGER	M. MIYATA	R. YUZON, JR.

THE DETAILED DESIGN STUDY OF THE NORTH-SOUTH COMMUTER
 RAILWAY PROJECT (MALOLOS-TUTUBAN)
 DETAILED DESIGN
PIER TYPE P2 - REINFORCEMENT DETAILS
SHEET 6

DATE	SCALE	SHEET No.	DRG No.	DRG S.	REV
OCTOBER 2017	AS SHOWN		NSCR-DWG-VIA00-ST-0616		01