

General Bid Bulletin No. 17
07 July 2021

RESPONSES TO CLARIFICATIONS

IFB No. 21-058-5; South Commuter Railway Project for Package Number CP S-03b; Civil Engineering, Tunnel and Building Works for Approximately 6.1km Railway with 4.7km of Underground Railway and 1.4km of At-Grade Railway, Including FTI Station and Tunnelling Works to Connect to MMSP Senate Station

TO ALL PROSPECTIVE BIDDERS:

This General Bid Bulletin is issued to amend/clarify certain provisions in the Bidding Documents for the above-mentioned project. Please refer to the ATTACHED Annexes of this General Bid Bulletin duly approved by the End-user and Co-Implementer for details:

1. **Annex "A"** – CP S03B Responses to Clarification Requests (Batch 7)

For the information and guidance.

For the Bids and Awards Committee V,



SIGNATURE REDACTED

JULIUS M. SANTOS

Chairperson

General Bid Bulletin No. 17
CP S30B Responses to Clarification Requests (Batch 7)

No.	Packages	Vol	Sec	Page No.	Clause No./Title	Reference Text (if necessary)	Clarification Request	Collated Response
1	S-03B						Please advise when will be the commencement date(YY-MM) for S-03b to help bidders to plan an appropriate mobilization schedule for his competitive proposal.	Reference is made to the Project Implementation Schedule (for information only) as included in the Site Data, see Bid Addendum 1
2	S-03B	Vol. 1A	Section 4A Bidding Forms – Bill of Quantities	63/91	BILL OF QUANTITIES No. 7 STATION CIVIL STRUCTURE WORKS (UNDERGROUND)		The Bidder found 2 types of excavation item in the bill of quantities: Excavation and Excavation (Rock). Please provide the classification criteria.	The classification criteria of Excavation and Excavation (Rock) shall refer to the DPWH (Department of Public Works and Highways – Standard Specification for Highways Bridges and Airport) 102.1.1 Roadway Excavation. This criteria is included in the Technical Specification and provided in Bid Addendum 2
3	S-03B	Vol. 2	Section 6 II Drawings	NSRP-GN-CE-CD-0012	PACKAGE CP S-03b: GENERAL NOTES AND COMMON DETAILS		The referred drawing provides general facilities which are required in the TBM tunnel. Amongst them, only the Trough Deck, Evacuation Passage and Handrail shall be part of the Contractor's scope of work. Please confirm.	Item 1~ 24 in the Legend of "NSRP-GN-CE-CD-0012" are part of the scope for CP106. For the coordination and interface requirements Bidder is referred to GS Appendix 4. Handrail, Trough Deck and Evacuation passage are included in the scope of CPS03b and are also included in the BOQ. Please note this drawing only showing the Facilities General Drawing, please also refer to other drawings/specifications for the Contractor's detailed scope.
4	S-03B	Vol. 2	Section 6 II Drawings	NSRP-GN-CE-CD-0012	PACKAGE CP S-03b: GENERAL NOTES AND COMMON DETAILS		The referred drawing mentions that "Note : This drawing is to show the general arrangement of civil facilities. The Contractor shall refer to CP106 for other facilities." Please provide the reference in relation with the aforesaid CP106.	The drawing presents scope of CP106 which has to be read together with the requirements in GS Appendix 4. An updated drawing will be provided with Bid Addendum 3.
5	S-03B	Vol. 2	Section 6 II Drawings	Varies	PACKAGE CP S-03b: CONSTRUCTION PLAN DRAWINGS		The Bidder understands that the referred drawing set is result of the detail design but many of them are annotated as "reference only". In particular the drawings NSRP-UT-CE-GN-0003 which contains borehole data also has the note "Reference only". Considering the design responsibility, the note may cause confusion. Please clarify.	In the case of the construction plan drawings, the specified construction methodology and specified temporary facilities are the Contractor's responsibility. Therefore these drawings are , it is marked as "reference only".
6		Vol. 2 Part II – Requirements	Section 6 - Employer's Requirements IB – General Specification	GS 89	Part 1 -Specification 1B – General Specification - GS 126.7	Quite apart from those delay damages however, where one Interfacing Contractors work is delayed due to a failure on the part of another, increased or additional costs are likely to be claimed against the Employer under the terms of the third-party contract. In the event the Employer should be obliged to compensate any such third-party claims, the amount paid shall, subject to Clause 2.5 of the GCC, be counter-charged against the defaulting Contractor. Such charge would constitute general damages, and would not be included within any calculation of delay damages limits under GCC Clause 8.7.	Taking into account that the fundamental purpose for the Delay Damage is to compensate the Employers for losses they suffer as a consequence of delayed completion of Works, it is interpreted as that the last and penultimate paragraphs of General Specification 126.7 impose to further compensate the Employer's losses on the Contractor in addition to the Delay Damage. Moreover, it is concerned that these obligation may increase the Contractor's burden and risks for the Works and it would causes difficulties for the bidders to submit their competitive commercial proposals. Therefore, please consider to remove the aforementioned paragraphs in General Specification 126.7.	GS will be amended and provided with Bid Addendum 3. FIDIC will take precedence in case of inconsistencies.
7		Vol. 2	Section 6 II Drawings		Underground Drawings - General Note and Common Details	Waterproofing General Drawings: Sheet 1/3 (NSRP-GN-CE-CD-0018) Soilder Pile General Drawings (NSRP-GN-CE-CD-0022) Soilder Pile Removal General Drawings: Sheet 1/2 (NSRP-GN-CE-CD-0023) Soilder Pile Removal General Drawings: Sheet 2/2 (NSRP-GN-CE-CD-0024)	The Bidder found general drawings for soilder pile. But no details are provided other than those general drawings. Please provide the details.	The water proofing shown in these drawings are for reference purpose only. The water proofing shall be designed by the Contractor in compliance with requirements in TS and the proposal shall be submitted by the Contractor to the Engineer for approval. The referred soldiers piles are king posts and are for reference purpose only. The kingposts shall be designed by the Contractor and subject to approval by the Engineer. The drawing NSRP-GN-CE-CD-0018 and other relevant drawings will be amended accordingly and issued as Revision 21.3 with Bid Addendum 3.

No.	Packages	Vol	Sec	Page No.	Clause No./Title	Reference Text (if necessary)	Clarification Request	Collated Response										
8		Vol. 3	Section 8 PCC	PCC4	4.14 Avoidance of Interference	Traffic Regulation for Soil Improvement Works for the East-West Underground Passage. The Contractor shall liaise and coordinate with the Authorities and obtain the permit of traffic control plane and works shall be mandatory implemented under the following conditions: (a) Window time of Six (6) hours a day from 23:00 hours till 5:00 hours next morning. (b) The works shall be completed within Twenty-three (23) days.	The Bidder understands that the time restriction specified in the referred clause shall be only applicable to the soil improvement work (chemical injection), whereas the underground passage construction is not subject to this clause. Please confirm.	The Bidder shall be determine the construction methodology the for the East- West Underground Passage without hindering disrupting traffic. The provision for Soil Improvement is an exception. DOTr had discussed and got the initial consent from the Authorities for the current design and to use the pipe-jacking methodology. The Bidder shall be required to prepare the necessary implementation plans based on this understanding.										
9		Vol. 3	Section 8 PCC	PCC4	4.14 Avoidance of Interference	ditto	Please provide the details and requirements for: 1) injection method, 2) protection and reinstatement of the existing road, 3) traffic control and; 4) the extent of the controlled area.	1)Employer assumes a typical soil improvement method from the existing ground surface. 2) The Bidder has to reinstate the holes used for soil improvement works shall reinstated at the end of each day being subject to further liaison and approval from relevant authorities. 3)&4) All required traffic control arrangements shall be responsibility of the Bidder.										
10		Vol.2	Section 6 1E-1 - Underground Technical Specifications (UTS)	115	2008.17 Contractor's Tests of Steel Reinforcing Bars	For each batch of steel reinforcing bars delivered to site, test specimens shall be taken from different bars in the batch to undergo the testing and the rate of testing shall be in accordance with Table 2008.17.1. Note: Yellow highlight is added by the Bidder for ease of reference	The referred clause requires the Contractor to carry out sampling and testing of rebar for every 10 tones. The requirement appears too onus in consideration of the Bidder's experience in the similar projects. Please reconsider easing the requirement. <table border="1" data-bbox="1037 659 1383 789"> <caption>Table 2008.17.1 Rate of Purchaser's Tests</caption> <thead> <tr> <th>Description</th> <th>Size of Batch</th> <th>Tensile</th> <th>Bending</th> <th>Mass per meter</th> </tr> </thead> <tbody> <tr> <td>Steel reinforcing bar</td> <td>Every 10 tons or fraction thereof</td> <td>1</td> <td>1</td> <td>1</td> </tr> </tbody> </table>	Description	Size of Batch	Tensile	Bending	Mass per meter	Steel reinforcing bar	Every 10 tons or fraction thereof	1	1	1	The requirement shall not be amended
Description	Size of Batch	Tensile	Bending	Mass per meter														
Steel reinforcing bar	Every 10 tons or fraction thereof	1	1	1														
11		Volume 2			Site Office/TBM Operations Site		NSRP-UT-CE-FTI-0004 below seems to suggest that the 5,227m2 is to be used as site office. But NSRP-UT-CE-FTI-0005 shows that the below site is used for TBM operations. Please confirm which is correct 	<i>Construction Plan</i> The building shown in NSRP-UT-CE-FTI-0004 is the NSRP Office (maintenance & station) and is part of the Design and Build scope, reference is made to the Outline Design Specification for the various requirements. The construction of the office building can only commence after the closure of the launching shaft and temporary road. Therefore, it can be used as a construction yard first - Please refer to the NSRP-UT-CE-GN-0001 construction schedule. Since it is part of the D+B scope the Building Office is part of the design of the Intermodal Transfer Facility. The exact location is to be determined by the Contractor. The location of the Building Office is for information only. The wording of site office, will be amended Building Office, and issued with Bid Addendum 3.										
12		Volume 2			Cross Passage Opening		There is no drawing showing cross passage opening. Is the Employer going to issue mopro drawings showing cross passage opening and staging drawings? Or it is up to the Contractor to propose and provide temporary design?	The Employer is not planning to issue more drawings regarding the cross passage opening during the Bidding stage. Please note it is Contractor's scope for any temporary work design.										
13		P2_S6_II(DWG)_31Mar2021_15_SPL_FTI					Intermodal Transfer Facilities: Please advise if the 3 areas as indicated on the reference drawings are within the scope of the is contract. Our understanding was that the Intermodal Facilities under this contract were located at Entrance 3 Western Plaza. Please clarify. 	The scope of the West Plaza is part of the Build only scope, reference is made to inter alia the BOQ and Drawing: NSRP-DWG-FTI-AR-3115-3118, 3523-3524, 3537-3538, etc. The three area as referred to in P2_S6_II(DWG)_31Mar2021_15_SPL_FTI are indeed part of the Design and Build Scope (Intermodal Transfer Facilities).										

No.	Packages	Vol	Sec	Page No.	Clause No./Title	Reference Text (if necessary)	Clarification Request	Collated Response
14		Volume 1	Section 4				<p>Due to the personal data privacy laws implemented in various countries (i.e. Personal Data Privacy Ordinance in Hong Kong, Data Privacy Act in the Philippines), some of our proposed personnel are not able to provide their Date of Birth as required in Form PER-2, and copies of education certificates, proof of vocational training and continuing certification as mentioned in BF23.</p> <p>Instead, we can provide their years of experience and qualification details (i.e. educational qualifications).</p> <p>Please confirm the acceptability of the above submission.</p>	<p>Entering the bidding process is voluntary and so there would be no data privacy issue if the prospective bidder will give consent to sharing the data/information for transparency purposes. The bidding process is a mechanism to ensure transparency in procuring and entering into government contracts, funded by public money. Data privacy laws should not be invoked to justify non-submission of required information for a Tender that a prospective Bidder is voluntarily participating. The use and disclosure of the data are only in furtherance of the Project as required by Law. The Employer shall exercise a degree of care to protect the Data from misuse and unauthorized access or disclosure.</p>
15		Volume 1A Section 4A Bill of Quantities Detailed Design Structural Drawings	Section 4A Bill of Quantities	Bill No. 5 NSRP- DWG-FTI- ST-4411	Item No. 408(14) Structural Steel (For Additional Support of Overhead Catenary Contact System) FTI Station Steelwork Roof Details-Sheet 1	Catenary Support Post-Typical Detail	<p>In NSRP-DWG-FTI-ST-4411, there is a typical detail for catenary support, however it is indicated in Note 4 in the same page that catenary support details is still for confirmation. Kindly provide its finalized details. Refer to Annex 1.</p>	<p>For Catenary Support Post refer to the revised drawing NSRP-DWG-FTI-4411 rev.21.3, which will be issued with Bid Addendum 3 and the specifications. Please refer to Bill 5 Pay item 408(14) Structural Steel (For Additional Support of Overhead Catenary Contact System)</p>
16		1.3 CP S-03b Vol 1A	Sec 4A BOQ 20210406	Bill No. 6a	Item No. 528(35)	N/A	<p>Please specify location of W12: W=4050mm x H=1650mm Fixed Steel Louver for West Station Plaza.</p>	<p>Schedule W12 was removed due location will be having duct works equipments. See window schedule NSRP-DWG-FTI-AR- 3563, rev 21.2 dated 20 May 2021. Pay item 528(35) will be deleted in Bill 6a in the BOQ and submitted with Bid Addendum 2.</p>

No.	Packages	Vol	Sec	Page No.	Clause No./Title	Reference Text (if necessary)	Clarification Request	Collated Response
17		CP S-03b, Vol.2, Scope of works		page 20	Item 2.2.5	Relocations (PNR tracks..	Is there any tentative dates and duration for this? Kindly provide relocation schedule / Site Delivery Access Schedule	PNR will relocate the tracks before commencement of the works. Any further relocation of tracks will be coordinated by the Contractor with PNR to suit the Contractor's construction programme. Reference is made to the Provisional Sum 18
18		Volume 1A, Section 4A & Volume 2, Section 6 & Volume 1A, Section 4A		13 of 91 & 31 of 37 (ER 29) & 82 of 91	Bill of Quantities No.1 (BOQ No.1), GS118 - Environmental Management & IA - Scope of Works, Appendix 2: Historic Buildings and Structures & Bill of Quantities No.11, Schedule of Provisional Sums	<p>GS118(6): Obtain Approval Notice to alter status of Historic Buildings and Structures within PNR RoW</p> <p>GS118(7): Protection of Historical Structures and Buildings (listed in Appendix to Scope of Works)</p> <p>GS118(11): Demolish Buildings/Structures, recover and make an inventory of any rail materials and other artifacts dating from after the Philippines-American War used as construction material</p> <p>GS118(12): Demolish Buildings/Structures, dispose of arisings off-site unless agreed otherwise with the Engineer</p> <p>GS118(13): Grub up ground slabs and foundations of Buildings and Structures already demolished to ground level</p> <p>GS118(14): Demolition of Historical Structures and Building &</p> <p>SCRP CP S-03b - List of Historical Sites - Database: Empty</p> <p>1. Items to be protected in place: Not applicable</p> <p>2. Items to be carefully taken apart for reassembly/rebuilding elsewhere: Not applicable</p> <p>3. Items to be removed intact, stored and repositioned on site later: Not applicable</p> <p>4. Items to be rooved intact, stored and exhibited off site: Not applicable</p> <p>5. Items to be demolished, when demolishing, recover and make an inventory of any rail materials and other artefacts from after the Philippine-American War used as construction material: Not applicable</p> <p>&</p> <p>PS-4: Historical PNR Structures Protection / Relocation / Demolition including PS-4A, PS-4B and PS-4C</p>	<p>Pay Item Nos listed herein are given as part of Lump Sum Works (LS) in BOQ No.1 however, if the List of Historical Sites - Database is checked in Section 6, Appendix 2, it will be seen that there is not any historical site listed for Package S-03b and, each further work requirement is stated as "Not applicable".</p> <p>In addition to above, Protection / Relocation / Demolition of Historical PNR Structures are - meanwhile- also listed under Schedule of Provisional Sums (PS-4 including PS-4A, PS-4B and PS-4C)</p> <p>In consideration of above and to avoid any discrepancy, the Bidder kindly requests the Employer to clarify if there is any historical building under Package S-03b and, -if available- which actions to be taken further.</p> <p>The Employer is also kindly requested to clarify either these works shall be considered as part of Lump Sum (LS) or Provisional Sum (PS) Works</p>	<p>There is no historical sites listed for Package S-03b.</p> <p>If there will be unforeseen historical structures found during execution of the works, this will be fall under the Provisional Sum.</p>
19		Volume 1A	Section 4A	-	Bill of Quantities (BOQ) No.1 (in general)	Time Related Charges (in general)	Time related charges are given in BOQ No.1 as Lump Sum (LS) only. In order to make a better assumption, please inform the Bidders for estimated durations and/or start & finish dates of each related work. Please also clarify how the time related charges will be paid (i.e. in number of months?)	Fixed charges and time related charges shall be provided separately within Bill No. 1 General Requirements. Lump Sum Fixed charges will be once only payments for mobilization and demobilization. Lump Sum Time related charges will be spread over the Contract Period. The Contractor shall provide a detailed build up for each Lump Sum.
20		Volume 2		21 - 23	NSRP-DWG-FTI-AR-3106 to 3108	Basement 2 - Platform & Ground Floor - Entrance 3, Ground Floor - Platform	Is there a need to provide Braille signs or Braille Layout Map? Not indicated @ Drawings	Yes, this is necessary and is part of the Design and Build Scope. Reference is made to the Outline Design Specifications, including the relevant building codes and standards.
21		Volume 2		21 - 23	NSRP-DWG-FTI-AR-3106 to 3108	Basement 2 - Platform	Is there a need to provide Seating Areas with Wheelchair space for handicapped, Control room & Concessions like newstand and emergency medical supplies?	Yes, this is necessary and is part of the Design and Build Scope. Reference is made to the Outline Design Specifications, including the relevant building codes and standards.

No.	Packages	Vol	Sec	Page No.	Clause No./Title	Reference Text (if necessary)	Clarification Request	Collated Response
22		Volume 2		17 - 19	NSRP-DWG-FTI-AR-3102 to 3104	Basement 1	Is there a need to provide signages like Entrance Signage, Station Name Signage, Map Signage? Not indicated @ Signage layout	Yes, this is necessary and is part of the Design and Build Scope. Reference is made to the Outline Design Specifications, including the relevant building codes and standards.
23		Volume 2		17 - 19	NSRP-DWG-FTI-AR-3102 to 3104	Basement 1	Is there a need to provide Tactile Hazard Markings/Warning Strips on Basement 1 Concourse (station entrances, escalator landings, stairwells (@ first and last step), and passenger lift accesses)? Not reflected on drawings	Yes, this is necessary and is part of the Design and Build Scope. Reference is made to the Outline Design Specifications, including the relevant building codes and standards.
24		Volume 2		17 - 19	NSRP-DWG-FTI-AR-3102 to 3104	Basement 1	Is there a need to provide Interactive Inquiry Centers (ICC), Tourist Information Booth Counter, Foreign Currency Exchange Counter, Public Security Stations, Help Points for Handicapped? Not Reflected on plan	Yes, this is necessary and is part of the Design and Build Scope. Reference is made to the Outline Design Specifications, including the relevant building codes and standards.
25		Volume 2		25	NSRP-DWG-FTI-AR-3110	Ground Floor - Entrance 1 Main Building NSRP Office	Is there a need to provide Ramp at Entrance?	Yes, this is necessary and is part of the Design and Build Scope. Reference is made to the Outline Design Specifications, including the relevant building codes and standards.
26		Volume 2		28	NSRP-DWG-FTI-AR-3113	Ground Floor - Entrance 2	Is there a need to provide Tactile Strip from Main Entrance going to Stairs and Elevator? Not reflected on plan	Yes, this is necessary and is part of the Design and Build Scope. Reference is made to the Outline Design Specifications, including the relevant building codes and standards.
27		Volume 2		28	NSRP-DWG-FTI-AR-3113	Ground Floor - Entrance 2	Is there a need to provide Wall railings from Station Entry going to Stairs and Elevator? Not reflected on plan	Yes, this is necessary and is part of the Design and Build Scope. Reference is made to the Outline Design Specifications, including the relevant building codes and standards.
28		Volume 2		28	NSRP-DWG-FTI-AR-3113	Ground Floor - Entrance 2	Is there a need to provide Audible Indicators @ Escalators? Not indicated @ Drawings	Yes, this is necessary and is part of the Design and Build Scope. Reference is made to the Outline Design Specifications, including the relevant building codes and standards.
29		Volume 2		28	NSRP-DWG-FTI-AR-3113	Ground Floor - Entrance 2	Is there a need to provide Braille signs or Braille Layout Map? Not indicated @ Drawings	Yes, this is necessary and is part of the Design and Build Scope. Reference is made to the Outline Design Specifications, including the relevant building codes and standards.
30		Volume 2		55 & 56	NSRP-DWG-FTI-AR-3401 & 3402	Station Office	Different Door Tag on Detailed Plan (D1) and Elevation (D2)	Station Office is D2; Kindly refer to NSRP-DWG-FTI-AR-3561, rev. 21.2 dated 20 May 2021 provided with Bid Addendum 2 and NSRP-DWG-FTI-AR-3401, rev.21.3 which will be provided with Bid Addendum 3.
31		Vol. 2 Section 6 II Drawings			DRG No. NSRP-DWG-ATG-ST-4002	At grade Schedule of Ground Treatment	-	The referred drawings specifies the requirement for removal and replacement with 500mm thickness of crusher mix to part of U-shape structure. However, the Bidder fails to identify the work in the bill of quantities. Please clarify. Ground treatment typical detail shall be added on NSRP-DWG-ATG-ST-4002 with including the section for Type 1 removal and replacement with 500mm thick crusher details and will be provided including a revised BOQ with Bid Addendum 3.
32		Volume 3	Section 7	4 / 39	The General Conditions of Contract (GCC)	"The Conditions of Contract have been prepared for an ad measurement (unit price or unit rate) type of contract and cannot be used for other types of contract."	Please clarify the term ad measurement.	The quantities in the BOQ are accurate and measured from Detailed Design. Admeasurement is the measurement of change from Detailed Design to revised Detailed Design and /or Variations as instructed by the Engineer. Further, any obvious errors detected in quantification in the BOQ shall, subject to the agreement of the Engineer, be re-measured and corrected. The Contractor is not expected to take the risk of errors in quantities. Any discrepancy will be amended / revised in the respective Bidding Documents with Bid Addendum 3.

No.	Packages	Vol	Sec	Page No.	Clause No./Title	Reference Text (if necessary)	Clarification Request	Collated Response
33		Volume 1A	Section 4A	5 / 91	Preamble to Bill of Quantities / Clause. 8	"8. The prices set out in the Bill of Quantities as Lump Sum are fixed prices except where otherwise specifically provided for in the Contract."	Please clarify the tender is a Lump-Sum price and the GCC to be followed is FIDIC MDB Harmonized Construction Contract which is a re-measurement type of Contract.	<p>The quantities in the BOQ are accurate and measured from Detailed Design. Admeasurement is the measurement of change from Detailed Design to revised Detailed Design and /or Variations as instructed by the Engineer.</p> <p>Further, any obvious errors detected in quantification in the BOQ shall, subject to the agreement of the Engineer, be re-measured and corrected. The Contractor is not expected to take the risk of errors in quantities.</p> <p>Any discrepancy will be amended / revised in the respective Bidding Documents with Bid Addendum 3.</p>
34		Volume 1A	Section 4A	5 / 91	Preamble to Bill of Quantities / Clause. 1	<p>"2. The Bill of Quantities are approximate and are given to provide a common and basis for bidding. The Bill of Quantities shall be read in conjunction with the Scope of Works, with the General and Technical Specifications and Drawings, the Instructions to Bidders and the General and Particular Conditions of Contract.</p> <p>...</p> <p>4. The basis of payment for Works designed by the Employer will be the actual quantities of work ordered and carried out in conformity with the Specifications and the Drawings, as measured by the Engineer and valued at the rates and prices in the priced Bill of Quantities, where applicable, and otherwise at such rates and prices as the Engineer may fix within the terms of the Contract. The quantities increased due to the Contractor's fault in complying with the Specification and/or the Drawings shall not be taken account for payment. No allowance shall be made for cutting, waste, laps or circular work."</p>	Please clarify that the Bidder does not have any quantity responsibility during the execution of the works according to the FIDIC MDB Harmonized Construction Contract which is a re-measurement type of Contract.	<p>The quantities in the BOQ are accurate and measured from Detailed Design. Admeasurement is the measurement of change from Detailed Design to revised Detailed Design and /or Variations as instructed by the Engineer.</p> <p>Further, any obvious errors detected in quantification in the BOQ shall, subject to the agreement of the Engineer, be re-measured and corrected. The Contractor is not expected to take the risk of errors in quantities.</p> <p>Any discrepancy will be amended / revised in the respective Bidding Documents with Bid Addendum 3.</p>
35		<p>Drg NSRP-UT-CE-FTI-004 in P2_S6_II(DWG)_31Mar2021_06_Civil_UT</p> <p>P2_S6_II(DWG)_31Mar2021_04_Civil_FTI</p>					Please clarify the location and details of Emergency Staircases 2 & 3.	<p>Emergency Staircase 2 is located in between Grid 34 and 35 . Entrance 2 is located between Grid 41 and 42.</p> <p>The structural details of the entrance/ES/ventilation shafts are supposed to be done during the detailed design stage.</p> <p>Please refer to structural drawing and architectural drawings for exact location.</p> <p>NSRP-UT-CE-FTI-0004 will be amended with Bid Addendum 3.</p>

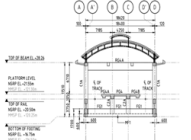
No.	Packages	Vol	Sec	Page No.	Clause No./Title	Reference Text (if necessary)	Clarification Request	Collated Response
36		Volume 2		NSRP-DWG ST-4200; Gen Specs Appendix 7, GS 131 pp		At grade Typical Section - distance of PNR relocated tracks to permanent structure	The section shown on drawing will not comply to the minimum distance specified in GS 131 which is 2m from face of fence to nearest rail. Besides, there is not enough safe space/clearance to construct retaining wall let along the side drainage. Can the relocated tracks be farther away from the proposed permanent structure?	Bidder shall consider working time & working method in accordance with the amendments in GS 131 as provided in Bid Addendum 1. This condition shall be subject to approval by Engineer.
37		Volume 1	Section 4 Bidding Forms		Bid Security		Please confirm whether Client is amenable to indicating in the date portion of the Bid security "Effective date from ____ to ____." This merely specifies the latest exact specific date per bid security clause whereas the guarantee will expire "(ii) 28 days after the expiration of the Bidder's bid." Please refer to below "Beneficiary: [Name and address of the Employer] Date: Effective date from ____ to ____ Bid Security No.:"	The Bidder shall strictly follow the standard template as provided.
38		Volume 2	Section 6, General Specifications GS100 - Appendix 3	Page 25	7.7.4 Safety Health	During construction, safety codes and regulations should be observed and accidents prevented by the appropriate safety and health administration	The requirements referred to earlier in this document (page 5 and 6) including the reference to the "Guidance for the Management of Safety for Construction Works in Japanese ODA Projects" provide guidance on a more general level. For the specific and detailed requirements in the tunnelling works, does the employer see British Standard BS 6164 "Health and safety in tunnelling in the construction industry" as a relevant guidance document?	The Employer is considering to adapt other international accepted standards and will amend the specification, which will be issued with Bid Addendum 3.
39		Volume 3	Section 8, Particular Conditions of Contract	PCC 8 & 9	Attachment 1- Summary of Key Dates	in the summary table of key dates, KD02N-2-Railway Electrical House MMSP FTI Station is 1795 days from Commencement. However, KD02M- Railway Electrical House MMSP FTI station is 1521days from Commencement.	Are these two Key dates on the same plant room? or this electrical house serve for both NSRP and MMSP? Please clarify	The Key Dates will be amended (including the ECP) and issued with Bid Addendum 3.
40		Volume 2	Section 6, Employers Requirements, IA - Scope of Work		Section 2.3	Entrance Building 1	Please clarify if the at-grade portion of Entrance Building 1 is part of the scope of under CP S-03b. Only the SCRP At-Grade Station is clearly defined as part of the scope under Section 2.3 of the Scope of Work document. If it is part of 3b, please clarify if this item is under design and build scope as there are no structural details available in the issued documents.	Structural Drawings of Entrance Building 1 is covered in the Design and Build scope
41			Section 6, Employers Requirements, IA - Scope of Work		Section 2.5.1	"- Platform and roof between Axis 17 and Axis 43 on the Ground Level;" "- At-grade building between Axis 43 and Axis 55 on the Ground Level;" 	Please clarify the items mentioned herein as we are unable to find the corresponding drawings/details/information among the issued documents.	For Grid 17 & 43 for platform and roof details, Kindly refer to : NSRP-DWG-FTI-AR-3304, rev. 21.3 which will be issued with Bid Addendum 3 and NSRP-DWG-FTI-AR-3119-3124; For Grid 43 & 55 for at-grade building details, Kindly refer to: NSRP-DWG-FTI-AR-3304; NSRP-DWG-FTI-AR-3421-3423 rev. 21.3 which will be issued with Bid Addendum 3.

ANNEX 1

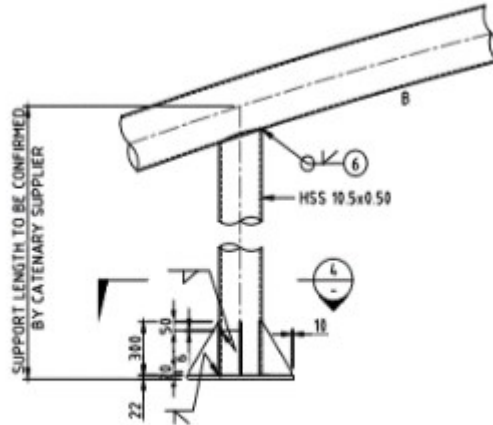

CATENARY SUPPORT POST- TYPICAL DETAIL(REFER NOTE 4)

SCALE 1:20

NOTES

1. FOR GENERAL NOTES AND LEGEND, REFER TO DRAWINGS NSRP-DWG-STA-ST-4001 TO 4003
2. ALL DIMENSIONS ARE IN MILLIMETERS AND ELEVATIONS ARE IN METERS UNLESS NOTED OTHERWISE.
3. TRUSS FABRICATOR TO SUBMIT SPLICE LOCATION AND SITE WELDING PROCEDURE TO THE ENGINEER FOR APPROVAL.
4. CATENARY SUPPORT DETAILS TO BE CONFIRMED ONCE CATENARY DETAILS FINALIZED.
5. FOR MEMBER SCHEDULE REFER TO DRAWING NSCR-DWG-FTI-ST-4403.